



Pneumatic Spring Return Automated Ball Valve Package

Series 22
Direct Mount

Full Port Valve

800/1000 psi WOG
(by size)

2-Piece
High Cycle Design

Available 1/4" – 3"

Direct Actuator Mount

316SS Body, Ball
and Stem



Direct Mount

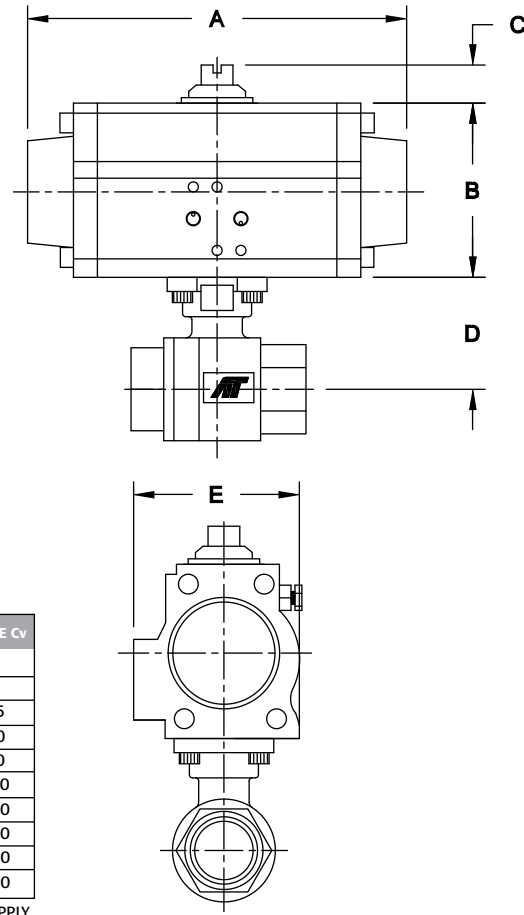

VALVE SIZE	A	B	C	D	E	VALVE Cv
1/4"	7.60	2.76	0.79	1.53	2.58	7
3/8"	7.60	2.76	0.79	1.53	2.58	8
1/2"	7.60	2.76	0.79	1.60	2.58	15
3/4"	7.95	3.43	0.79	1.82	3.29	40
1"	7.95	3.43	0.79	2.24	3.29	70
1-1/4"	9.29	4.49	0.79	2.40	4.41	110
1-1/2"	9.29	4.49	0.79	3.06	4.41	250
2"	9.29	4.49	0.79	3.35	4.41	350
2-1/2"	11.46	5.28	0.79	4.31	5.20	600
3"	13.90	6.18	0.79	4.63	6.04	900

DIMENSIONS SHOWN FOR ASSEMBLIES SIZED FOR 80 PSI SUPPLY.

SERIES 22 2-Piece Direct Mount

SIZED FOR 80 psi AIR SUPPLY

SIZE	MODEL
1/4"	22-TX-025/TR1S-XX
3/8"	22-TX-038/TR1S-XX
1/2"	22-TX-050/TR1S-XX
3/4"	22-TX-075/2R2S-XX
1"	22-TX-100/2R2S-XX
1-1/4"	22-TX-125/2R3S-XX
1-1/2"	22-TX-150/2R3S-XX
2"	22-TX-200/2R3S-XX
2-1/2"	22-TX-250/2R5S-XX
3"	22-TX-300/2R6S-XX

SIZED FOR 60 psi AIR SUPPLY

SIZE	MODEL
1/4"	22-TX-025/TR1S-XX
3/8"	22-TX-038/TR1S-XX
1/2"	22-TX-050/TR1S-XX
3/4"	22-TX-075/2R2S-XX
1"	22-TX-100/2R3S-XX
1-1/4"	22-TX-125/2R3S-XX
1-1/2"	22-TX-150/2R4S-XX
2"	22-TX-200/2R4S-XX
2-1/2"	22-TX-250/2R5S-XX
3"	22-TX-300/2R6S-XX

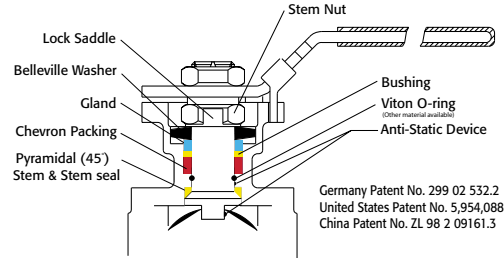

Germany Patent No. 299 02 532.2
United States Patent No. 5,954,088
China Patent No. ZL 98 2 09161.3

SAMPLE PART #

22-TX-100/2R3S-XX

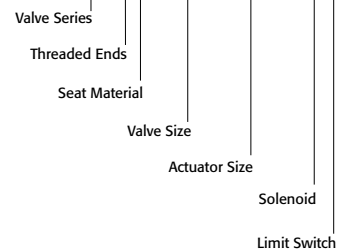

OPTIONS

DESCRIPTION	PART NO. SUFFIX	DESCRIPTION	PART NO. SUFFIX
NEMA 4 Solenoid	(A)	NEMA 4 Limit Switch (2) spdt	(A)
NEMA 7 Solenoid	(B)	NEMA 7 Limit Switch (2) spdt	(B)

Other options available - call for details
Actuators are sized based on clean/clear fluid.

See valve part number matrix for complete part number and options.

050111-22SR



Triac Division
11363 Deerfield Rd.
Cincinnati, Ohio 45242
PHONE (513) 247-5465
FAX (513) 247-5462
e-mail: sales@a-tcontrols.com
www.a-tcontrols.com