

INSTALLATION & MAINTENANCE MANUAL

SERIES F91 UNI-BODY, FLANGED, REDUCED PORT VALVE

Brief Introduction

Series F91 is uni-body (1-piece) valve, with “floating ball” design. Induced by the line pressure the ball is free to move horizontally inside the valve body.

1. USE:

- 1.1 Life of valve can be maximized if the valve is used within the rated range, in accordance with pressure, temperature, and corrosion data.

2. MANUAL OPERATION:

- 2.1 To open or close the valve, turn the handle ¼ turn (90 degrees).
 - A. Valve in Open Position – the handle is in parallel (in-line) with the valve or pipeline.
 - B. Valve in Closed Position – the handle is perpendicular (crossed) with the valve or pipeline.

3. AUTOMATED OPERATION:

- 3.1 Valves with actuators should be checked for valve stem alignment. Angular or linear misalignment will result in high operational torque and unnecessary wear on the stem seal.

4. GENERAL INFORMATION FOR ON-SITE INSTALLATION:

- 4.1 The valve may be fitted in any position on the pipeline.
- 4.2 To prevent damage to the seats and ball surface, the pipeline must be flushed, free of dirt, burrs, and welding residues before installing the valve.

5. DISASSEMBLING & CLEANING THE VALVE:

- 5.1 If the valve has been used in hazardous media, it must be decontaminated before disassembly.
- 5.2 As shipped from the factory, valves contain silicone-free based lubricant. If Lubricant is unacceptable for your particular application, you may disassemble the valve and wash the parts in solvent.

6. REPLACING THE THRUST WASHER AND PACKING

- 6.1 Before replacing the thrust washer and the packing, the pipeline must be de-pressurized.

Note: Stem seal leakage may be corrected without replacing the seal and/or packing. Tighten the packing nut to flatten the Belleville washers. If leakage continues or valve's operating torque becomes excessive, the seals are worn and must be replaced.

- A. Remove nuts and lift the valve from the line. Care should be taken to avoid scratching or damaging serrated gasket. The valves are heavy, and they should be adequately supported before removing it from the line.
- B. Loosen the handle nut and remove handle and stop pin. Next, loosen the stem nut and remove Belleville washers and gland.
- C. Remove end cap using proper wrench.
- D. Remove body seal, Seat and ball.
- E. To take out the ball, rotate stem so ball is in fully closed position. Lift ball from the body, using a strap and lift device, if necessary. Extreme caution should be taken to avoid damage to the ball.
- F. Take out the other seat.
- G. Stem must be removed from inside the body. A tap to the top of the stem should loosen it. The thrust washer should come out with the stem. Then, remove the stem packing.

7. VISUAL INSPECTION:

7.1 Clean and inspect metal parts. It is not necessary to replace neither ball nor stem unless the surface has signs of abrasion or corrosion. We strongly recommend replacement of all soft parts whenever the valve is disassembled for reconditioning. We provide replacement kits that contain all the replaceable parts.

Note: The valve may be assembled and operated dry with any lubricant. However, a light lubrication will aid in assembly and reduce initial operating torque. Lubricant used must be acceptable with the intended line fluid.

8. ASSEMBLY

Install one seat in the body cavity with the spherical curvature facing the ball.

- 8.1 Install the thrust washer on stem and slide the stem up through the body. Install packing, gland, belleville washers. Screw the stem nut into the stem.
- 8.2 Install handle and washer.
- 8.3 Screw the stem nut into the stem until the handle is secure.
- 8.4 Turn handle to the closed position. Line up the ball slot with the stem end and slide the ball into position. Turn the handle to the open position to hold the ball in place.
- 8.5 Install the remaining seat into body side.
- 8.6 Put body gasket into body and seat into the valve. Be careful not to damage body seal when putting cap end into body.
- 8.8 Install end cap. Extreme care must be exercised during adjustment of end cap.
- 8.9 Cycle the valve slowly, with a gentle back and forth motion, to build gradually to the full quarter turn. By cycling slowly, the seat lips will assume a permanent seal shape against the ball. A fast turning motion, at this point, may cut the seats before they have a chance to form the proper seal.
- 8.10 Test valve, if possible, prior to placing valve back into line position. If not properly secured, the valve can separate from the pressure source, resulting in possible injury.

TEST AS FOLLOWS:

- A. Secure valve to a test fixture by means of a mating flange with full bolting and a suitable gasket. Orient valve so seat to be tested is facing up.
- B. Introduce 50 to 100 psig air. Partially cycle the valve, under pressure, then slowly close to make sure the cavity is pressurized (use hearing protection). Pour water into the upper port to cover the ball and visually check for bubbles. If bubbles appear, pour the water out, cycle the valve several times and recheck. To check for leakage in the other port, reverse the valve and introduce air pressure to the port just checked.
- C. Check stem seal at this time by coating the stem top area with a water/soap solution. If leakage occurs, tighten stem seal just until leakage stops.
- D. Make sure the handle in the correct position.

Valve Size	Break Away Torque (In-lbs.)	Torque of Stem Nut (In-lbs.)
1/2"	110	104
3/4"	115	104
1"	145	104
1-1/2"	320	148
2"	415	191
2-1/2"	450	191
3"	600	191
4"	1043	260
6"	2130	347

MATERIALS LIST

NO.	PART NAME	MATERIAL	QTY
1	Body	CF8M / WCB	1
2	Cap	CF8M / WCB	1
3	Ball	SUS 316	1
4	Seat	RPTFE	2
5	Joint Gasket	PTFE	1
6	O-RING	VITON	1
7	Stem	SUS 316	1
8	Stem Seal	RPTFE	1
9	ORING	VITON	1
10	Gland Packing	PTFE	§
11	Gland Packing	25% Glass Fiber Filled + PTFE	1
12	Gland Bush	SUS 304	1
13	Belleville Washer	SUS 301	2
14	Stop Washer	SUS 304	1
15	Stem Nut	SUS 304	2
16	Stem Washer	SUS 304	1
17	Handle	SUS 304	1
18	Stop Pin	SUS 304	1
19	Locking Device	SUS 304	1
20	Handle Sleeve	VINYL	1
21	Pin Nut	SUS 304	1
22	Anti-static Device	SUS 304	2

§ 1/2"-11/2"- 2 pcs, 2-4"-3pcs.

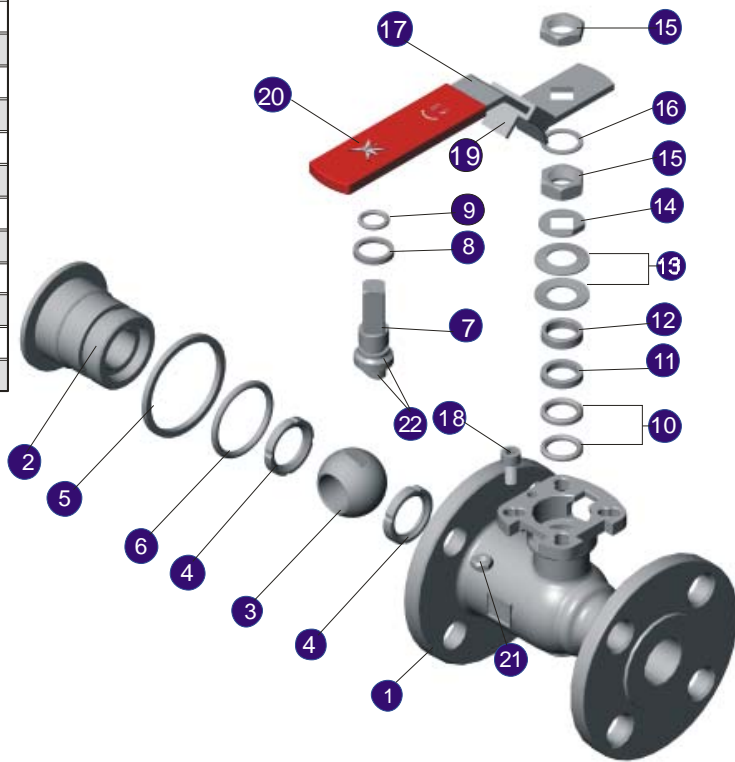

A-T Controls product, when properly selected, is designed to perform its intended function safely during its useful life. However, the purchaser or user of A-T Controls products should be aware that A-T Controls products might be used in numerous applications under a wide variety of industrial service conditions. Although A-T Controls can provide general guidelines, it cannot provide specific data and warnings for all possible applications. The purchaser / user must therefore assume the ultimate responsibility for the proper sizing and selection, installation, operation, and maintenance of A-T Controls products. The user should read and understand the installation operation maintenance (IOM) instructions included with the product, and train its employees and contractors in the safe use of A-T Controls products in connection with the specific application.

While the information and specifications contained in this literature are believed to be accurate, they are supplied for informative purposes only. Because A-T Controls is continually improving and upgrading its product design, the specifications, dimensions and information contained in this literature are subject to change without notice. Should any question arise concerning these specifications, the purchaser/user should contact A-T Controls.

For product specifications go to <http://download.a-tcontrols.com/>

A-T Controls, Inc. • 9955 International Boulevard, Cincinnati, OH 45246 • Phone: (513) 530-5175 • Fax: (513) 247-5462 • www.a-tcontrols.com