



487

V11.2013

INSTRUMENTS • VALVES • CONTROLS

Chicago Area Office
135 Bernice Dr, Bensenville IL 60106
Ph: 800-953-7626 • 630-595-8400
Fax: 630-595-2386

Milwaukee Area Office
5160 N 125th St, Butler WI 53007
Ph: 800-837-1700 • 262-923-1790
Fax: 262-923-1797

E-mail: sales@lesman.com

Contact: _____ Ext. _____

Name: _____

Company: _____

Street: _____

City: _____ State: _____ Zip: _____

E-mail Address: _____

Phone: (____) _____ Fax: (____) _____

This is a: Request for Quote Order: PO# _____

Quantity Needed: _____ Date Required: ____/____/____

Shipping Method: _____ Partials Accepted: Yes No

Magnetic Level Indicator
Application Datasheet



Process Conditions

Process Liquid: _____

Min. Specific Gravity: _____

Min. Normal Max. Units

Process

Pressure: _____ PSI bar

Process

Temperature: _____ °C °F

- High Vibration Interface
Capability to Boil or Flash Specific Gravity: _____
ASME B 31.3 ASME B 31

Design Information

Center to Center: _____

Indicator Dimension (if other than C to C): _____

Process Connection: Welded Threaded Flanged

Connection Size: 1/2" 3/4" 1"
 1-1/2" 2" 2-1/2" 3"

Flang Rating: 150# 300# 600#
 900# 1500# 2500#

Chamber Material: 316 SS 304SS
 Hastelloy CS/WLC

Vent or Drain Type: Hex Plug NPT
 Flanged Valve

Vent or Drain Size: 1/2" 3/4" 1"

Indication Style: Bargraph without Scale
 Bargraph with Scale
 Bargraph with Scale (%)
 Other: _____

Engineering Units: Metric Imperial

Optional Output

Transmitter: Magnetostrictive Reed
 Other: _____

Reed Accuracy: 5mm 10mm 15mm 18mm

Switch: Dry Contact Reed
 Other: _____

Switch Type: SPDT DPDT SPDT-HT DPDT-HT

Testing and Documentation

- CRN PMI (Third Party)
Dye Pan Fillet Welds Visual
Hydrochart X-Ray Butt Welds
Hydrotest Certificate 100% Final
Material Certification 10% Spot
NACE Other: _____
PMI

Mounting and Orientation

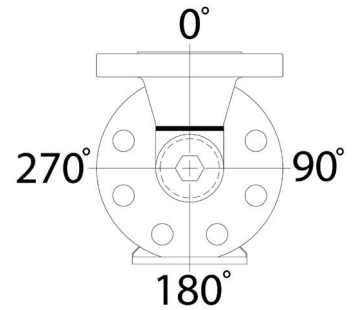
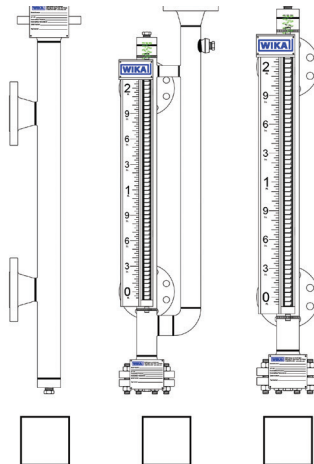

- Indicator Transmitter Switches
 270° 270° 270°
 180° 180° 180°
 90° 90° 90°

Special Instructions/Notes: